

Copyright © 2007 SDA Design & Architecture Ltd  
 All rights reserved  
 Decisions from this drawing are made on the basis of information and/or data provided to SDA Design & Architecture Ltd. SDA Design & Architecture Ltd is not responsible for any errors or omissions in this drawing or for any consequences arising therefrom. SDA Design & Architecture Ltd is not responsible for any errors or omissions in this drawing or for any consequences arising therefrom. SDA Design & Architecture Ltd is not responsible for any errors or omissions in this drawing or for any consequences arising therefrom.

Residence	Room	Date	Description	Author
A	21.10.13	21.10.13	For parking amended as requested by Planning Department	SNL

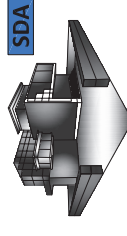

**SDA Architecture**  
 8 BLOSSOM HILL, WINDY HILLS, WINDY HILLS  
 OFFICE TEL: 01842 610335 - Fax: 01842 663274  
 MOBILE: 07780 60212  
 WWW: www.sdaarchitecture.co.uk  
 Company Registration England & Wales No: 031887

*Making Dreams Reality...*

**SITE LOCATION PLAN**

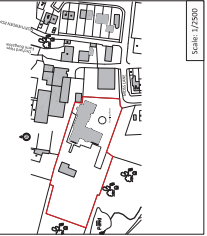

**PROJECT INFORMATION**

Client: M & Management, Mr. Houson	Project Description: Proposed 28 Bedroom Extension
Site Address: The Bratches Nursing Home	State: PLANNING PERMISSION
Date: 07/08/2012	Drawing Title: Sheet Size: A1 Scale: 1:200
Drawn By: SNL	Scale: 1:200

**Parking Plan & Site Topography Survey as Proposed**

Job Number: 170	Drawing Number: PL-08	Revision: A
-----------------	-----------------------	-------------

DO NOT SCALE

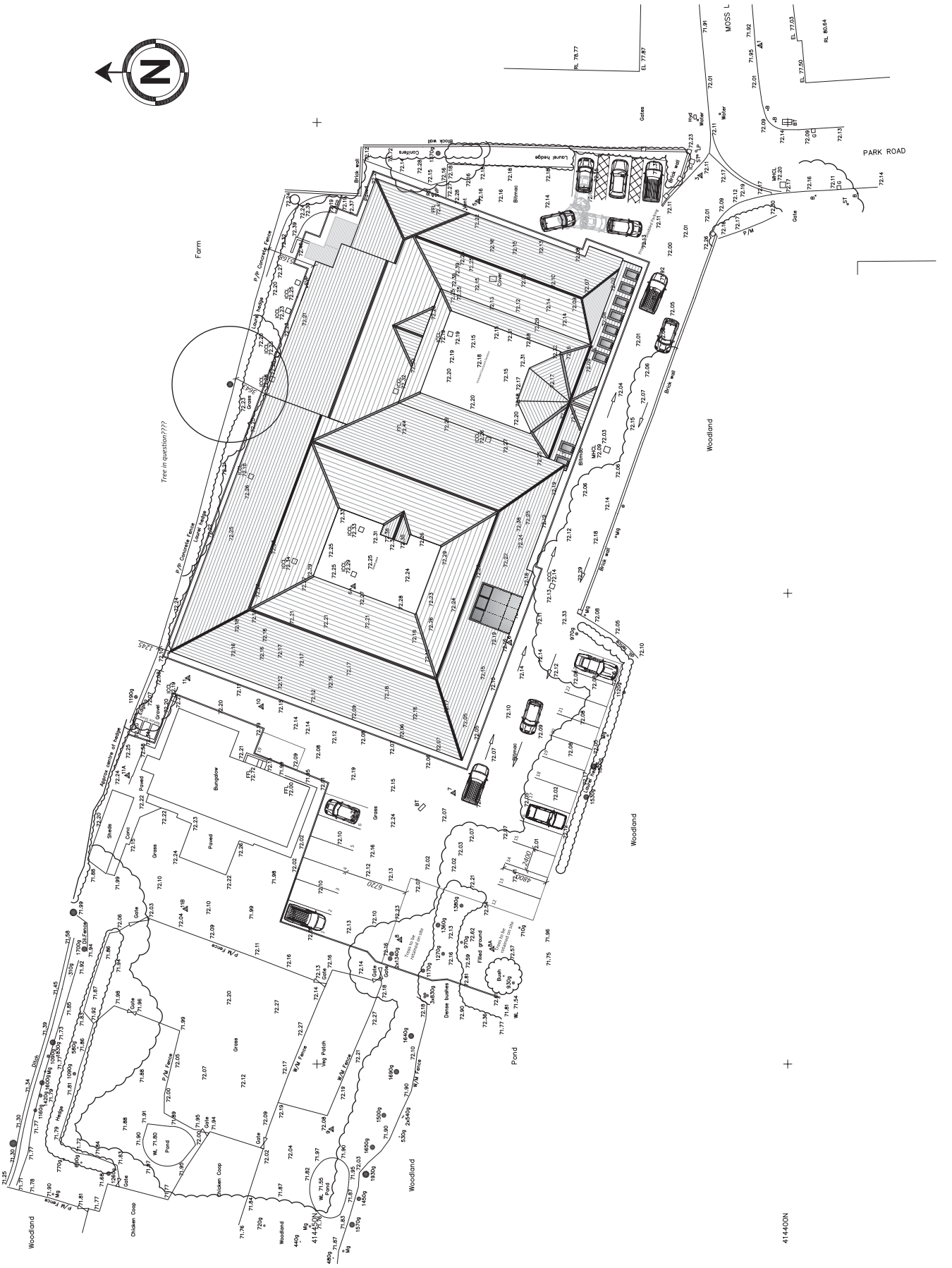
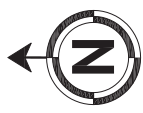

**PROPOSED**

414400N